

NEW ZEALAND – BAY OF ISLANDS, FIORDLAND & STEWART ISLAND 7, 8, 9 or 10-nights small ship cruising in some of the southern hemisphere's most scenic locations



Here is an opportunity to explore New Zealand in the same way as you can on the small luxury cruise boats and barges of France. 'Island Escape' is a beautifully appointed small ship with a stunning interior. Newly launched in 2021 and equipped to travel to inaccessible areas, she offers the highest level of passenger comfort with 17 spacious ensuite suites with ocean views, a large dining room/saloon lounge, a library, and generous outdoor living spaces.

The small ship carries two landing craft, two large tenders, sea kayaks, a five-seat helicopter, fishing and snorkeling equipment; for those looking for less strenuous activities, lazing in a deckchair is always an acceptable option. During each journey, our 14 person crew is on hand to share their knowledge of the ocean and local landscapes. For those interested in fishing, several levels are available during the cruises to suit everyone from the novice to the more experienced angler.

In the galley, our chefs work with the freshest local ingredients and delicacies to create memorable meals that reflect the day's adventures. The ship accommodates a maximum of 32 passengers, and departures are subject to a minimum number of 12 passengers.

Costs from: \$7,895 per person (twin share) in a main deck Ocean Suite on a 7 night cruise.



Call OUTDOOR TRAVEL on 1800 331 582 for details or reservations

COSTS PER PERSON (TWIN SHARE) FROM:

All prices shown in Australian dollars

NEW ZEALAND - BAY OF ISLANDS

Departs: From/to Auckland: 5th, 12th, 19th, 26th December 2021
8 days / 7 nights

Ocean Suites: \$7,895
Solo Suite: \$11,875
Horizon Suite: \$10,880
Owners Suite: \$12,870

NEW ZEALAND - MILFORD SOUND & FIORDLAND

Departs: From/to Queenstown
8th, 22nd January, 5th, 19th February, 19th March, 2nd April 2022
9 days / 8 nights

Ocean Suite: \$9,890
Solo Suite: \$13,860
Horizon Suite: \$12,870
Owners Suite: \$14,855

NEW ZEALAND - DUSKY SOUND & SOUTH FIORDLAND

Departs: From/to Queenstown
15th, 29th January, 12th February, 12th, 26th March, 9th April 2022
10 days / 9 nights

Ocean Suite: \$10,880
Solo Suite: \$14,855
Horizon Suite: \$13,860
Owners Suite: \$15,850

NEW ZEALAND - STEWART ISLAND

Departs: Queenstown/to Bluff 25th February 2022
Bluff /to Queenstown 6th March 2022
9 days / 8 nights

Ocean Suite: \$9,890
Solo Suite: \$13,860
Horizon Suite: \$12,870
Owners Suite: \$14,855

Ocean Deck

- Solo Suites
- Ocean Suites
- Ocean Twin Suites



Horizon Deck

- Owners Suite
- Horizon Suites

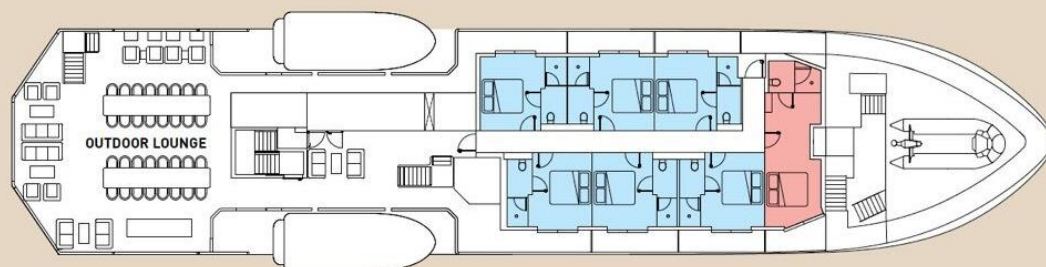

Ocean Suites: 8 x Main Deck, King/Twin beds (17sqm) & 2 x Singles 14sqm
Horizon Suites: 6 x Upper Deck with balcony, King/Twin beds (19sqm)
Owners Suite: 1 x Upper Deck with balcony, King bed (26sqm)

Included: onboard accommodation in air-conditioned cabins with ensuite bathrooms; daily cabin cleaning; all onboard chef prepared meals; full bar onboard including wine, beer, spirits, bottled water; expedition leaders, scheduled guided small boat excursions and sport fishing trips, use of kayaks, paddleboards, snorkel & fishing equipment; unlimited WiFi; all taxes and port charges.

Not included: Meals & beverages taken onshore, gratuities, personal expenses.

Call OUTDOOR TRAVEL on 1800 331 582 for details or reservations



NEW ZEALAND - BAY OF ISLANDS CRUISING

8-days / 7-nights – Cruising amidst marlin, dolphins and legends...

Suggested itinerary: (Please note itinerary is subject to change due to weather/sea conditions)

Day 1 Auckland

Make your way by 5pm to the Princes Wharf to board the ship. Enjoy cocktails on deck as the ship cruises out of Waitemata Harbour, with evening views of Auckland's waterfront, harbour bridge and skyline. Head into the Hauraki Gulf, passing Devonport's North Head and the dormant volcanic island of Rangitoto, we anchor for dinner and an overnight stay in a secluded bay at Waiheke Island.

Day 2 Waiheke Island

Rise early for a swim off the stern of the ship before breakfast. Then head ashore to Oneroa, Waiheke's township, full of funky craft shops, galleries, eateries as well as local Waiheke wines and produce. Return to the ship for lunch and the cruise out to Great Barrier Island across Hauraki Gulf, with a chance to spot dolphins and whales. The anchorage tonight is the island's beautiful, natural Port Fitzroy Harbour.

Day 3 Great Barrier Island

Great Barrier Island is wild, remote and unspoilt and Fitzroy Harbour has a colourful history of whaling, gold mining, shipwrecks and alternative lifestyles. Today explore the island's coastline by landing craft with the First Mate and maybe try a spot of fishing in these abundant waters. After dinner, we cruise north towards the Bay of Islands under clear dark skies that offer stargazers a spectacular view.

Day 4 Bay Of Islands

Overnight, we round Cape Brett and anchor in the beautiful turquoise waters of Oke Bay. Feel free to dive off the stern and swim to the white sandy beach before breakfast. After breakfast enjoy a scenic helicopter flight to get stunning views across the Bay of Islands. Spend the afternoon bay-hopping, swimming and exploring the beaches or just relax aboard. Arrive at tonight's anchorage, Parekura Bay, just before sunset and dinner.

Day 5 Bay Of Islands

Head west to Motuarohia-Roberton Island and moor up exactly where Captain James Cook anchored Endeavour in 1769. There are many ways to explore the island; snorkel in the lagoon, kayak around the Bay or hike up to the historic Maori Pa site, with its panoramic views. After lunch, we cruise back across to Urupukapuka island to collect green-lipped mussels. They make a lovely afternoon snack served with a chilled Sauvignon Blanc and herbs from our chef's on-board garden. We anchor for the night off Russell.

Day 6 Bay Of Islands

After breakfast, explore Russell, a town of rich history. Known in the old whaling days as the lawless 'the hellhole of the Pacific', it became the first capital of New Zealand in 1840. Russell today retains an old-world charm, with many shops and cafes. Take a ferry across the Bay and visit the Waitangi Treaty Grounds before returning to Russell's waterfront in the afternoon, gathering at the Duke of Marlborough Hotel's veranda bar. Enjoy a drink here with the Captain while overlooking the Bay before returning to the ship for dinner. Overnight we head south again, returning to Waiheke Island.

Day 7 Waiheke Island

Returning to the opposite end of Waiheke Island in time to go ashore and visit Ostend Market, Waiheke's Saturday morning craft and produce fair. Vineyard and olive oil tasting tours are next on the itinerary. Waiheke has a multitude of wineries and produces some of New Zealand's best wines. In the afternoon, the First Officer will lead a fishing trip to help supply our chef with fresh ingredients for our celebratory dinner party tonight.

Day 8 Auckland

Lifting anchor at 7.30 am, say farewell to Waiheke and breakfast is served on deck as we cruise back to into Auckland. Disembarkation is from 9am alongside Princes Wharf.



NEW ZEALAND - MILFORD SOUND & FIORDLAND NATIONAL PARK

9-days / 8-nights - Cruising deep within the stunning World Heritage National Park

Suggested itinerary: (Please note itinerary is subject to change due to weather/sea conditions)

Day 1 Queenstown

Meet at Queenstown Airport and be transferred to the Heritage Hotel. Spend time exploring in this beautiful alpine village, with dinner at your own arrangement.

Day 2 Queenstown / Fiordland / Doubtful and Nancy Sounds

After breakfast, take a private coach transfer to Lake Te Anau and explore the lake and township if time permits. The helicopters depart from 2pm for a 20-minute scenic flight that delivers you to the heli-pad of the ship moored in Doubtful Sound. Cruise out towards the Tasman through Doubtful and Thompson Sounds and then north to the overnight anchorage in Nancy Sound for a chance to relax and take in the beautiful scenery.

Day 3 Nancy and Charles Sounds

Wake to the tranquillity of this World Heritage National Park and the lush, vertiginous scenery of Nancy Sound. From our anchorage, simply relax and enjoy the view or join a trip to explore the pristine shoreline of the fjord. With luck you might gather a crayfish with the help of the one of the crew or catch a fish at the head of the sound. After lunch set off north to explore the two arms of Charles Sound with its untouched natural beauty. Join the crew in a Zodiac for a trip up the Irene River that flows into the Emelius Arm of the Sound. Spend the evening at the head of Charles Sound, enjoying dinner, spectacular views and some fascinating local history.

Day 4 Bligh Sound

Depart Charles Sound after breakfast and cruise north to Bligh Sound. This fiord is an interesting Z-shape, named after William Bligh (of Mutiny on the Bounty fame), the then Governor of New South Wales. Anchor at beautiful Amazon Cove for lunch, then head ashore to explore and hear histories of lost tribes and the Wild Natives River. Back on-board, feel free to relax and take in the view. On clear evenings this is the perfect place for stargazing.

Call *OUTDOOR TRAVEL* on 1800 331 582 for details or reservations



Day 5 Milford Sound

We depart Bligh Sound and travel north again to explore world-famous Milford Sound. Cruising up the Sound and making stops to take a look at some of the many cascading waterfalls along the way. Circling through Harrison Cove, we reach an iconic New Zealand vista, Mitre Peak. Head back to Bligh Sound for the night, looking out for the wildlife; there are many sea birds, perhaps even albatross, pods of dolphins often ride the bow wave and occasionally you might sight whales.

Day 6 George Sound

After breakfast cruise on to George Sound, the longest fiord in northern Fiordland, to see the beautiful Alice Waterfalls. For those up for a good walk and breath-taking views, go ashore and take the track up above the falls to Alice Lake. Halfway along the fiord, arrive at Anchorage Cove at the mouth of the George River, a great spot to relax and enjoy a stroll along the deserted foreshore, before anchoring for the night.

Day 7 Caswell Sound

Arrive in Caswell Sound early where you might join a fishing trip to the head of the fiord with the one of the crew, hopefully, to restock the dinner supplies with fresh crayfish and blue cod. Or stay on board, and enjoy the views of the beautiful Ellice Falls and the majestic 1400 metre peaks that flank the sound. This evening enjoy a farewell dinner hosted by the captain and crew.

Day 8 Queenstown

After breakfast, take a helicopter to Te Anau, enjoying the scenic views with Mount Irene and Mount Lyall. Transfer back to the Heritage Hotel by mid-afternoon, with time to explore Queenstown a little more. Dinner is at your own arrangement tonight with many restaurants from which to choose.

Day 9 Tour ends in Queenstown

After breakfast, transfer to Queenstown Airport for your onward travel or ask us about extra nights of accommodation to extend your stay.



Call *OUTDOOR TRAVEL* on 1800 331 582 for details or reservations



NEW ZEALAND - DUSKY SOUND & SOUTH FIORDLAND

10-days / 9-nights - Cruising deep within the stunning World Heritage National Park

Suggested itinerary: (Please note itinerary is subject to change due to weather/sea conditions)

Day 1 Queenstown

Meet at Queenstown Airport, transfer to the Heritage Hotel, then have free time in this beautiful alpine village, with dinner at your own arrangement.

Day 2 Queenstown / Fiordland / Doubtful Sound

After breakfast, take a private coach transfer to Lake Te Anau and if time permits explore Te Anau township before a 20-minute panoramic, scenic flight to the heli-pad of the ship moored in Doubtful Sound. Cruise out towards the Tasman Sea along Doubtful Sound then down the coast to anchor for the night in Dagg Sound. Enjoy a welcome dinner that is served alfresco on the deck.

Day 3 Pickersgill Harbour

Depart Dagg Sound after breakfast heading south. Whales frequent the waters near the fiord entrance so head to the bridge deck to spot them. Enjoy lunch in Dusky Sound while the Captain gives an orientation of Fiordland's history and on Captain James Cook's visits to this part of New Zealand. After lunch head ashore in Pickersgill to explore the area where Captain Cook beached his ship Resolution in 1773 to repair her hull. Nearby is Astronomers Point, the site of a temporary observatory set up during Cook's stay. Back on-board, relax and take in the view. On clear evenings this is the perfect place for some stargazing.

Day 4 Dusky Sound

After breakfast cruise inland to the head of Dusky Sound and Supper Cove. This cove is the western trail-head for one of New Zealand's great wilderness hikes, the Dusky Track. Further on visit Cascade Cove, Cook Channel, Fanny Bay and Nine Fathom Passage. After lunch take a Zodiac boat ashore to visit the Seaforth Hut and explore the Seaforth River by Zodiac or on foot.

Day 5 Wet Jacket Arm

Cruise this morning to peaceful Sportsman's Cove for morning tea and more historic insight from the Captain. The focus remains on Cook and his journeys. Lunch is served underway as the ship cruises the Acheron Passage north and heads up Wet Jacket Arm to Herrick Creek, where there have been moose sightings reported. Anchor off Oke Island for the night.

Day 6 Breaksea Sound

We follow the inland Acheron Passage heading for Disappointment Cove at the mouth of Breaksea Sound. Look out for seals close to shore and dolphins approaching the ship. Today's lunchtime talk is on conservation history and efforts to mitigate the impact of introduced fauna to Fiordland. There is a stop at Sunday Cove for afternoon tea and an introduction to the local venison industry. Stay overnight further up Breaksea Sound in Third Cove, below Mount Kellard.

Day 7 Vancouver Arm

Explore the Vancouver and Broughton Arms today. Fishing trips are on the agenda throughout the day, hopefully to restock dinner supplies with fresh crayfish and blue cod. Non-fishers can go ashore to explore the intertidal shoreline and bush at a SW corner of Broughton Arm. Fresh fish for dinner is virtually guaranteed.

Day 8 Dagg Sound

Cruise out into the Tasman Sea for the short northbound passage to Dagg Sound, named after Captain William Dagg, an early seal hunter. Cruise deeper into the interior and anchor where Dagg Sound is almost connected with Doubtful Sound via Narrow Neck. This evening, enjoy a farewell dinner hosted by the captain and crew in this remote and tranquil setting.

Day 9 Queenstown

Return to Doubtful Sound, to rendezvous with the helicopters to fly to Te Anau. Enjoy another spectacular airborne transfer with views of Mount Irene and Mount Lyall. Transfer back to the Heritage Hotel by mid-afternoon, with time to explore Queenstown. Dinner is at your own arrangement tonight.

Day 10 Tour ends in Queenstown

After breakfast, transfer to Queenstown Airport for your onward travel or ask us about extra nights of accommodation to extend your stay.

Call OUTDOOR TRAVEL on 1800 331 582 for details or reservations



NEW ZEALAND – STEWART ISLAND

9-days / 8-nights - Cruising deep down South: from Queenstown to Bluff or v.v.

Suggested itinerary: (Please note itinerary is subject to change due to weather/sea conditions)

Day 1 Queenstown

Meet at Queenstown Airport and transfer to the Heritage Hotel with free time in this beautiful alpine village. Dinner is at your own arrangement.

Day 2 Doubtful Sound

After breakfast, take a private coach transfer to Lake Te Anau with time to explore Te Anau township before a 20-minute panoramic, scenic flight to the heli-pad of the ship moored in Doubtful Sound. Cruise to the Tasman Sea along Doubtful Sound then down the coast to anchor for the evening in Dusky Sound.

Day 3 & 4 Dusky Sound

The Captain begins with an orientation of Fiordland's history and on Captain James Cook's visits to this part of New Zealand. After lunch head ashore in Pickersgill to explore the area where Captain Cook beached his ship Resolution in 1773 to repair her hull. Nearby is Astronomers Point, the site of a temporary observatory set up during Cook's stay. Back on-board, relax and take in the view as on clear evenings this is the perfect place for stargazing. Explore inland to the head of Dusky Sound and Supper Cove, the western trailhead of the Dusky Track. Visit Cascade Cove, Cook Channel, Fanny Bay and Nine Fathom Passage and join the Zodiac's excursion to Seaforth Hut and the Seaforth River. Cruise on to Long Sound for the evening.

Day 5 & 6 Chalky Inlet, Preservation Inlet And Long Sound

Captain James Cook was the first European to see Taiari / Chalky Inlet during the 1773 voyage. He named the inlet after the white cliffs on the island's seaward side, but he did not enter the fiord. The first Europeans to do so came in 1813, aboard the cutter Snapper.

The first shore-based whaling station in New Zealand was established there in 1828, processing southern right whales. In the 1890s gold deposits were found but by 1904 only a few miners were left, and few traces remain. Pest control in Chalky Inlet has led to the islands there becoming a sanctuary for many native species which have been reintroduced since 2002 including the Mohua, Orange-fronted Kakariki, Little Spotted Kiwi and Tieke. With 3,672 hectares, Long Sound Marine Reserve is the largest in Fiordland.

Day 7 & 8 Paterson Inlet, Stewart Island

Arrive at Oban, the only town on Stewart Island, located in Halfmoon Bay within Paterson Inlet. Walk the numerous tracks across the island, kayak the coastline and cruise the very nearby islands. Ulva Island is a small island lying within Paterson Inlet, about 3.5 km long and only 267 hectares in area. Ulva Island's relative isolation and easy access have allowed it to become a sanctuary for both birds and plants, holding species that on the mainland of New Zealand are rare or extinct. The birds include the South Island saddleback, yellowhead, Stewart Island robin, southern brown kiwi, rifleman, yellow-crowned and red-fronted parakeet, South Island kaka and the endangered yellow-eyed penguin which uses the island for breeding.

Day 9 Tour ends in Bluff/Invercargill

We sail at breakfast to arrive alongside the main Bluff wharf by 10:30am and disembark by 11am.



Outdoor Travel offers this spectacular small ship expedition cruise in Australia, exploring the remote and timeless **Wild Kimberley Coast** and the World renown **Great Barrier Reef**.

We also offer a wide range of guided walking and cycling experiences in New Zealand including **Milford Sound Track**, **Routeburn Walk**, **Grand Traverse**, **Hollyford Track**, **Akaroa Walk** and **Queen Charlotte Walk** as well as the **Nelson Great Taste Trail**, **Queenstown Cycle Trail**, **Otago Rail Trail** and discover the **Marlborough Wine Region** by E-Bike.

Contact Outdoor Travel for more itinerary details and to make your reservation:

- Call Toll free 1800 331 582 or (03) 57551743 or Fax (03) 57501020
- Email: info@outdoortravel.com.au
- Web: <http://www.outdoortravel.com.au/>
- Mail: Outdoor Travel Pty Ltd, PO Box 286, Bright VIC 3741, Australia