

WESTERN AUSTRALIA – WILD KIMBERLEY COAST

13-day / 12-night small ship GUIDED adventure cruising from and back to Broome



Western Australia's largely untouched Kimberley coastline with more than 2600 islands, cascading waterfalls, reefs and crystal-clear water, is a must-see destination. It is one that deserves viewing from a unique perspective and the most relaxing way to do so is from a luxury yacht. Explore the unspoilt nature, ancient rock art and pristine white beaches while perfecting the art of sunset drinks. Sit back and enjoy as the amazing landscapes slip past from the comfort of your deck chair, get up close in one of our Zodiacs or take a guided hike ashore.

Here is an opportunity to explore Australia in the same way as you can on the small luxury cruise boats and barges of France. 'Island Escape' is a beautifully appointed small ship with a stunning interior. Newly launched in 2021 and equipped to travel to inaccessible areas, she offers the highest level of passenger comfort with 17 spacious ensuite suites with ocean views, a large dining room/saloon lounge, a library, and generous outdoor living spaces. The small ship carries two landing craft, two large tenders, sea kayaks, a five-seat helicopter, fishing and snorkelling equipment and for those looking for less strenuous activities, relaxing on deck is always an acceptable option. During each journey, our 14 person crew is on hand to share their knowledge of the ocean and local landscapes. For those interested in fishing, several levels are available during the cruises to suit everyone from the novice to the more experienced angler. In the galley, our chefs work with the freshest local ingredients and delicacies to create memorable meals that reflect the day's adventures. The ship accommodates a maximum of 32 passengers, and departures are subject to a minimum number of 12 passengers.

Departs: 2nd, 14th, 27th May, 8th, 21st June, 3rd, 16th, 28th July, 10th, 22nd August, 4th, 16th September 2022

Cost per person, twin-share from:	Ocean Suite	Solo Suite	Horizon Suite	Owners Suite
	\$14,855	\$19,325	\$18,335	\$20,815

Included: onboard accommodation in air-conditioned cabins with ensuite bathrooms; daily cabin cleaning; all onboard chef prepared meals; full bar onboard including wine, beer, spirits, bottled water; expedition leaders, scheduled guided small boat excursions and sport fishing trips, use of kayaks, paddleboards, snorkel & fishing equipment; unlimited WiFi; all taxes and port charges.

Not included: Meals & beverages taken onshore, gratuities, personal expenses.

Call OUTDOOR TRAVEL on 1800 331 582 for details or reservations

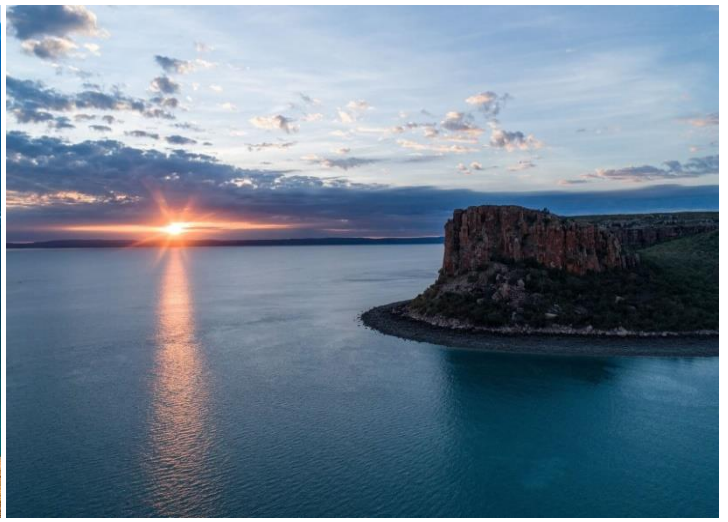

Ocean Deck

- Solo Suites
- Ocean Suites
- Ocean Twin Suites



Horizon Deck

- Owners Suite
- Horizon Suites

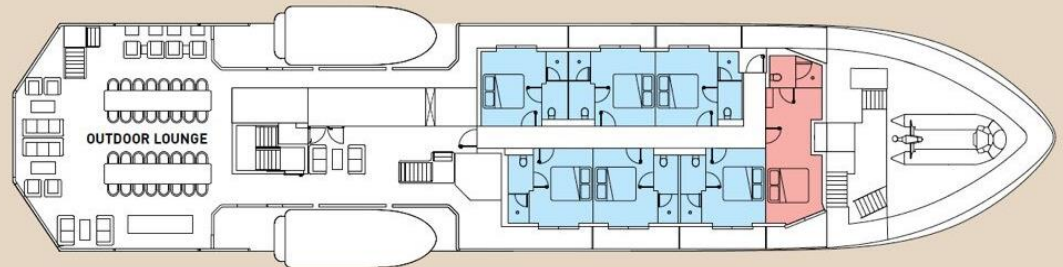

Ocean Suites: 8 x Main Deck, King/Twin beds (17m²) & 2 x Singles 14m²
 Horizon Suites: 6 x Upper Deck with balcony, King/Twin beds (19m²)
 Owners Suite: 1 x Upper Deck with balcony, King bed (26m²)



Call OUTDOOR TRAVEL on 1800 331 582 for details or reservations



Suggested itinerary: *please note itinerary is subject to change due to weather/sea conditions*

Day 1 Broome

Boarding commences in Broome at 3 pm for a 4 pm departure. Early arrivals can leave their luggage on-board and take time to explore the rich history of Broome or enjoy the 22km long Cable Beach. Once aboard join the Captain, his crew and fellow passengers for cocktails and canapés on deck. Our chefs have prepared a welcome dinner which will be served during the sunset cruise out of Broome.

Day 2 Horizontal Waterfalls

Enjoy an al-fresco breakfast on the aft deck of the ship and scenic views as the ship cruises through some of the 1000 islands of the Buccaneer Archipelago. Visit Australia's largest tides at the 'horizontal waterfalls'. The tidal movement in this area is huge, with some of the greatest tides on the planet. A vast amount of water endeavours to course through a small gap, creating a 4m wave rushing along at up to 20 knots. Another is Whirlpool Passage, which has land on one side and an island on the other, causing huge whirlpools. For a closer view, board a Zodiac and get 'really close' to these amazing acts of Mother Nature.

Day 3 Doubtful Bay

Wake up to views of Doubtful Bay, named by explorer Phillip Parker King who thought it was an entrance to the Mythical Inland Sea. After breakfast, take a Zodiac up the Sale River towards Red Cone Creek and the small but impressive Ruby Falls, surrounded by rock walls and from where you may be able to walk up to reach crocodile-free freshwater swimming holes and waterfalls. After a day of exploring, cruise to the next destination.

Day 4 Careening Bay

Overnight the crew have sailed the yacht to Careening Bay, an uninhabited raw natural beauty that has very limited access. Here you will find one of the most interesting historical features of the Kimberley, the 'Mermaid' boab tree. The carving on its bark, which is still well and truly visible today, is evidence of early European visits to the area. Philip Parker King careened HMC Mermaid on the beach in 1820. His crew inscribed the date and name of the Cutter on the large boab tree which is situated approximately 60 metres from the high water mark. Enjoy wonderfully crafted cocktails on deck as we sail with the sun setting on the horizon.

Day 5 Naturaliste Island – Mitchell Falls

We anchor near the mouth of the Hunter River and in front of the beautiful beach of Naturaliste Island. From this beach we will embark on a scenic helicopter flight to the famous multi-layered Mitchell Falls where emerald-tinted rock pools cascade down the slopes. Mitchell River National Park is populated by many bird species, reptiles, mammals, and amphibians. Here you will also view the indigenous flora, fauna, and ancient Aboriginal rock art sites. The sandstone platforms are a wonderful way to relish in the peacefulness of the spectacular terrain. We sail at 3pm along this wild Kimberley coast for Jar Island. The views from the aft deck bar and lounge are amazing.

Day 6 Jar Island, Vansittart Bay

Vansittart Bay is a picturesque, cultural, and historical must-see destination, named by Phillip Parker on one of his surveys of Northern Australia in the 19th century. Not only will you see pristine white beaches and glistening aqua waters, but you will also visit the grave of a DC3 aircraft. During World War II, the plane was on its way from Perth but needed to crash land onto the saltpan after it veered off course and ran out of fuel. It was on a mercy mission, clearing four Dutch citizens from the island of Java and all lived to tell the story. Also on display are the ethnic shards of pottery and Gwion Gwion rock art galleries dating back 40,000 years – Aboriginals name the paintings Gwion after the bird whose blood was used to create these artworks.

Call OUTDOOR TRAVEL on 1800 331 582 for details or reservations

Day 7 King George Falls

Welcome to the spectacular King George Falls, Western Australia's highest twin waterfalls which reaches approximately 100 metres. The King George River plunges down the red sandstone cliffs into flowing tidal water, creating the great King George Falls where our Zodiacs will take you close enough to be showered by the waterfall. You will spend the day exploring and savoring the overwhelming scenery the river has to offer and gaze in awe at the ancient wilderness coast that is only experienced by a small number of people. We sail to nearby Faraway Bay where we anchor for dinner before proceeding around midnight.

Day 8 Sailing

Today is dedicated to exploring the area further offshore. We arrive around the Sand and Cassini Islands for lunch. The area is well known as a turtle breeding area as well as a productive fishing location. We wind through the islands on the way to our anchorage at Swift Bay.

Day 9 Swift Bay

Swift Bay is home to a series of Wandjina art galleries, located only a short walk from the Zodiac landing. The area holds some of the largest aboriginal artwork dating back between 5,000 and 17,000 years. Birds, fish, turtles and Wandjina, the Aboriginal spirits who created the land and controlled the weather. After lunch, it is time to move and anchor at Winyalkan Bay and explore Hathaway's Hideaway. Be prepared to see geckos, bats, and other signs of life, albeit a long time ago when it was used as an Aboriginal midden. The curves and segments inside the cavern project the sensation of an optical dream, explains why they are often described as maze-like. In the evening enjoy the sun setting over the Indian Ocean whilst sipping delicious cocktails.

Day 10 Prince Regent National Park

This morning cruise through one of Australia's most important conservation sites, the Prince Regent National Park. Breakfast on the aft deck while cruising to King Cascade, a traditionally beautiful, terraced waterfall said to be the most photographed in the Kimberley. Tumbling from an impressive height and around 50m across, water dives down a staggered patio of Kimberley sandstone – welcome to King Cascade. Here our crew will position the zodiacs under the falls for a wonderful showering experience.

Day 11 Montgomery Reef

Today we visit Montgomery Reef, a remarkable naturally assorted coral reef covering nearly 300 square kilometres. Watch in awe as the monstrous Montgomery Reef rises out of the ocean at low tide, the outward development of the tide frames a downpour of water and falling cascades. The reef is biologically diverse and has a plethora of marine life as they try to escape the emerging reef. Octopuses, turtles, reef sharks and even dugongs, manta rays and dolphins are abundant. The reef and island were named by Philip Parker King, the first European to find the island in 1818. The reef was named after the ship's surgeon, Andrew Montgomery.

Day 12 Silica Beach and Cygnet Bay Pearl Farm

Wake up in beautiful Silica Beach, located on the remote Hidden Island, Silica Beach is known for its turquoise ocean and contrasting ivory sand. The white sand slants seaward between the headlands to more profound stone reefs, allowing small boat access. Here you will have the opportunity to relax and indulge in the wonderful views of the clear blue glistening water. After breakfast on the aft deck, we cruise towards Mission Bay for a tour of the Cygnet Bay Pearl Farm. This gives visitors an insight into the fascinating history of pearling in Cygnet Bay and how they cultivate some of the most sought-after and beautiful pearls in the world. The local tour guides will demonstrate a pearl harvest giving a glimpse into a fully operational pearl farm.

Day 13 Broome

The tour ends with disembarkation in Broome at 9:00am.

Your adventure starts and ends in Broome, which is well worth a few extra nights before or after your holiday. Ask for details of pre-tour accommodation and flights to complete your experience.

Outdoor Travel offers this spectacular small ship expedition cruise in **New Zealand**, including the **Bay of Islands, Milford Sound & Fiordland, Dusky Sound & South Fiordland & Stewart Island**. We also offer a wide range of guided walking and cycling experiences in **Australia & New Zealand**, including the **Great Ocean Walk & 12 Apostles, Queen Charlotte Walk** as well as the **Nelson Great Taste Trail, Queenstown Cycle Trail, Otago Rail Trail** and discover the **Marlborough Wine Region by E-Bike**.

Contact Outdoor Travel for more itinerary details and to make your reservation:

- Call Toll free 1800 331 582 or (03) 57551743 or Fax (03) 57501020
- Email: info@outdoortravel.com.au
- Web: <http://www.outdoortravel.com.au/>
- Mail: Outdoor Travel Pty Ltd, PO Box 286, Bright VIC 3741, Australia



Call OUTDOOR TRAVEL on 1800 331 582 for details or reservations